

## New drive pulleys with integrated rope tightening

The latest igus® drive unit is equipped with new pulleys (since July 2011). They enable the user to tighten the wires for the robolink arm easily.

The tension of the wires can be adjusted individually:

- ⇒ If the tension is too low: the joint will have play (will bounce).
- ⇒ If the tension is too high: friction in the system will rise, all components will be wearing faster

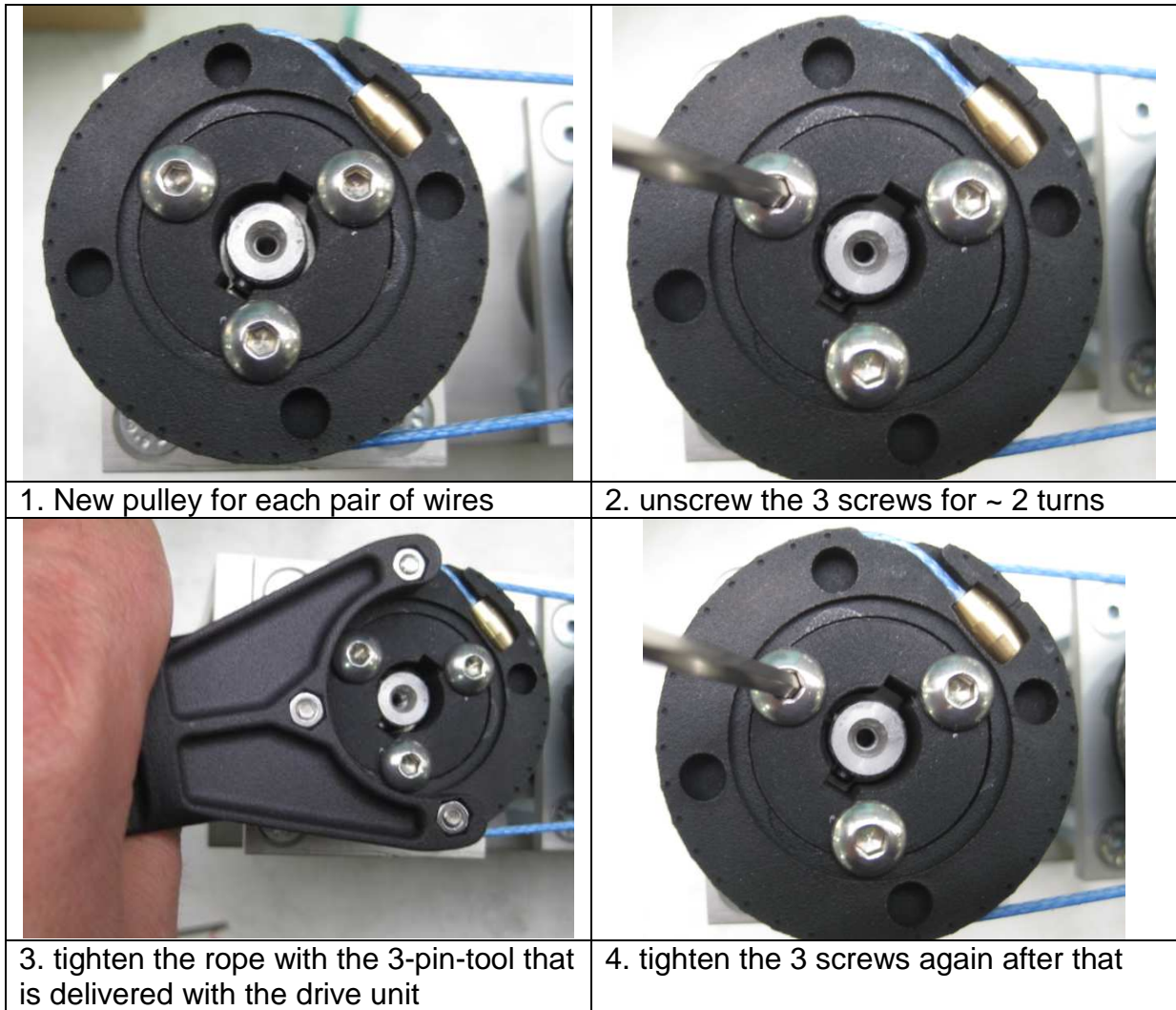

The following colours are used for the different movements:

