

stepper motor



- 2-phase hybrid stepper motor (bipolar)
- high protection class
- with plug or stranded wires
- optional with encoder / brake

part number													
MOT	AN - S - 060 - 020 - 056 - M - A - AAAA												
	<table border="1"> <thead> <tr> <th colspan="2">specifics</th> </tr> </thead> <tbody> <tr> <td>AAAA</td> <td>standard</td> </tr> <tr> <td>AAAC</td> <td>encoder</td> </tr> <tr> <td>AAAD</td> <td>encoder and brake</td> </tr> </tbody> </table>	specifics		AAAA	standard	AAAC	encoder	AAAD	encoder and brake				
specifics													
AAAA	standard												
AAAC	encoder												
AAAD	encoder and brake												
	<table border="1"> <thead> <tr> <th colspan="2">options</th> </tr> </thead> <tbody> <tr> <td>A</td> <td>without</td> </tr> <tr> <td>C</td> <td>incremental encoder</td> </tr> <tr> <td>D</td> <td>incremental encoder and brake</td> </tr> </tbody> </table>	options		A	without	C	incremental encoder	D	incremental encoder and brake				
options													
A	without												
C	incremental encoder												
D	incremental encoder and brake												
	<table border="1"> <thead> <tr> <th colspan="2">motor connection</th> </tr> </thead> <tbody> <tr> <td>M</td> <td>metric plug</td> </tr> <tr> <td>L</td> <td>stranded wire</td> </tr> </tbody> </table>	motor connection		M	metric plug	L	stranded wire						
motor connection													
M	metric plug												
L	stranded wire												
	<table border="1"> <thead> <tr> <th colspan="2">flange dimension</th> </tr> </thead> <tbody> <tr> <td>028</td> <td>28mm (NEMA11)</td> </tr> <tr> <td>042</td> <td>42mm (NEMA17)</td> </tr> <tr> <td>056</td> <td>56mm (NEMA23)</td> </tr> <tr> <td>060</td> <td>60mm (NEMA23XL)</td> </tr> <tr> <td>086</td> <td>86mm (NEMA34)</td> </tr> </tbody> </table>	flange dimension		028	28mm (NEMA11)	042	42mm (NEMA17)	056	56mm (NEMA23)	060	60mm (NEMA23XL)	086	86mm (NEMA34)
flange dimension													
028	28mm (NEMA11)												
042	42mm (NEMA17)												
056	56mm (NEMA23)												
060	60mm (NEMA23XL)												
086	86mm (NEMA34)												
	<table border="1"> <thead> <tr> <th colspan="2">holding torque</th> </tr> </thead> <tbody> <tr> <td>001</td> <td>0,1Nm</td> </tr> <tr> <td>005</td> <td>0,5Nm</td> </tr> <tr> <td>020</td> <td>2,0Nm</td> </tr> <tr> <td>035</td> <td>3,5Nm</td> </tr> <tr> <td>059</td> <td>5,9Nm</td> </tr> </tbody> </table>	holding torque		001	0,1Nm	005	0,5Nm	020	2,0Nm	035	3,5Nm	059	5,9Nm
holding torque													
001	0,1Nm												
005	0,5Nm												
020	2,0Nm												
035	3,5Nm												
059	5,9Nm												
	<table border="1"> <thead> <tr> <th colspan="2">max voltage</th> </tr> </thead> <tbody> <tr> <td>060</td> <td>60VDC</td> </tr> </tbody> </table>	max voltage		060	60VDC								
max voltage													
060	60VDC												
	<table border="1"> <thead> <tr> <th colspan="2">motor type</th> </tr> </thead> <tbody> <tr> <td>S</td> <td>stepper motor</td> </tr> </tbody> </table>	motor type		S	stepper motor								
motor type													
S	stepper motor												
	<table border="1"> <thead> <tr> <th colspan="2">type</th> </tr> </thead> <tbody> <tr> <td>AN</td> <td>version</td> </tr> </tbody> </table>	type		AN	version								
type													
AN	version												
	<table border="1"> <thead> <tr> <th colspan="2">product group</th> </tr> </thead> <tbody> <tr> <td>MOT</td> <td>motor</td> </tr> </tbody> </table>	product group		MOT	motor								
product group													
MOT	motor												

technical data						
flange dimension		28(NEMA11)	42(NEMA17)	56(NEMA23)	60(NEMA23XL)	86(NEMA34)
motor						
max voltage	[VDC]	60	60	60	60	60
nominal voltage	[VDC]	24-48	24-48	24-48	24-48	24-48
nominal current	[A]	1,0	1,8	4,2	4,2	6,4
holding torque	[Nm]	0,12	0,5	2,0	3,5	5,9
detent torque	[Nm]	0,004	0,022	0,068	0,075	0,210
step angle	[°]	1,8 ±5%	1,8 ±5%	1,8 ±5%	1,8 ±5%	1,8 ±5%
resistance / phase	[Ω]	2,30 ±10%	1,75 ±10%	0,50 ±10%	0,65 ±10%	0,33 ±10%
inductance / phase	[mH]	1,80 ±20%	3,30 ±20%	2,20 ±20%	3,20 ±20%	3,00 ±20%
moment of inertia / rotor	[kgcm ²]	0,018	0,082	0,48	0,84	2,70
max. shaft load axial	[N]	7	7	15	15	65
max. shaft load radial	[N]	20	20	52	63	200

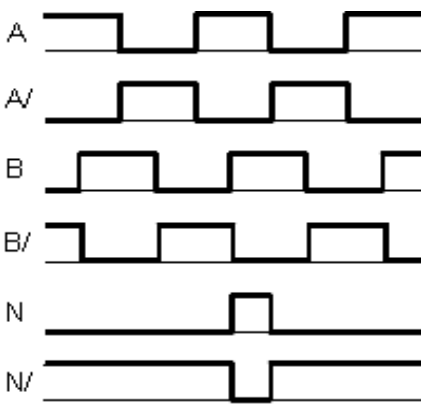
encoder		
operating voltage	[VDC]	5
impulse / turn		500
zero impulse / index		yes
line-driver		RS422 protocol
signal sequence (motor rotation clockwise)	CW	

brake						
operating voltage	[VDC]	-	24 ±10%	24 ±10%	24 ±10%	24 ±10%
wattage	[W]	-	8	10	10	11
holding torque	[Nm]	-	0,4	1,0	1,0	2,0
moment of inertia	[kgcm ²]	-	0,01	0,02	0,02	0,07
operating condition		The brake may closed not till then the motor idleness.				

weight						
stranded wires	[kg]	0,20	0,38	1,04	1,45	-
plug	[kg]	0,25	0,43	1,12	1,56	3,20
encoder	[kg]	0,27	0,45	1,14	1,58	3,30
encoder and brake	[kg]	-	0,58	1,36	1,82	3,60

operating data		
ambient temperature	[°C]	-10 ...+50
max temperature rise	[°C]	80
insulation class		B
humidity (not condensing)	[%]	85
protection class engine case		IP65 (shaft seal IP52), motor with stranded wires IP40
CE		EMV guideline

pin assignment stepper motor
 flange dimension 28(NEMA11) flange dimension 42,56,60(NEMA17,23,23XL)

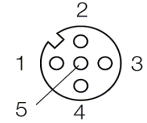
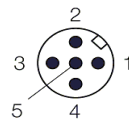
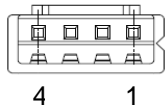

motor bipolar			
JST XHP-4			wires
pin	signal	phase	color
1	A	1	white
2	A/		brown
3	B	2	blue
4	B/		black

motor bipolar				motor cable
M12 5-pole			wires	M12 5-pole
pin	signal	phase	color	color
1	A/	1	brown	brown
2	A		white	white
3	B	2	blue	blue
4	B/		black	black
5	PE	-	-	green/yellow
housing	shielding	-	-	-

pin assignment stepper motor
 flange dimension 86(NEMA34)

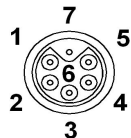
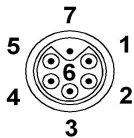

motor bipolar			motor cable
M17 7-pole			M17 7-pole
pin	signal	phase	number
1	A/	1	1
2	A		2
3	B	2	3
4	B/		4
5	brake 24V	-	5
6	brake 0V	-	6
7	PE	-	green/yellow
housing	shielding	-	shielding

pin assignmen brake/initiator
 flange dimension 42,56,60(NEMA17,23,23XL) flange dimension 86(NEMA34)

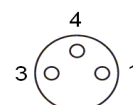
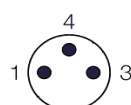
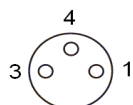
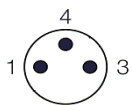

brake		brake cable
M8 3-pole		M8 3-pole
pin	signal	color
1	brake (24V)	brown
3	0V	blue
4	-	black

initiator		initiator cable
M8 3-pole		M8 3-pole
pin	signal	color
1	VDC	brown
3	0V	blue
4	switching signal	black

pin assignmen encoder
 flange dimension 28(NEMA11) flange dimension 42,56,60(NEMA17,23,23XL)

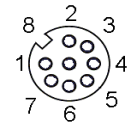
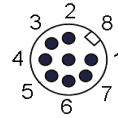
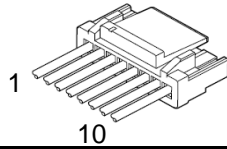
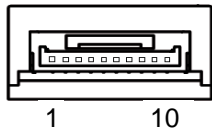

encoder connector		encoder plug
JST / SM10B-GHS-TB		JST / GHR-10V-S
pin	signal	color
1	shielding	-
2	A	-
3	A/	-
4	B/	-
5	B	-
6	N/	-
7	N	-
8	GND	-
9	5VDC	-
10	shielding	-

encoder		encoder cable
M12 8-pole		M12 8-pole
pin	signal	color
1	A	white
2	A/	brown
3	B	green
4	B/	yellow
5	0V	grey
6	N/	pink
7	N	blue
8	5V DC	red
housing	shielding	shielding

pin assignmen encoder
 flange dimension 86(NEMA34)

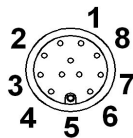
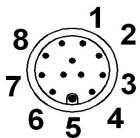

encoder		encoder cable
M17 12-pole		M17 12-pole
pin	signal	color
1	A	brown
2	A/	green
3	B	blue
4	B/	violet
5	0V	white 0,5 [□]
6	N/	grey
7	N	pink
8	5V DC	brown 0,5 [□]
9	-	-
10	-	-
11	-	-
12	-	-
housing	shielding	shielding

characteristic flange dimension 28 (NEMA11) MOT-AN-S-060-001-028-...	flange dimension 42 (NEMA17) MOT-AN-S-060-005-042-...
--	---

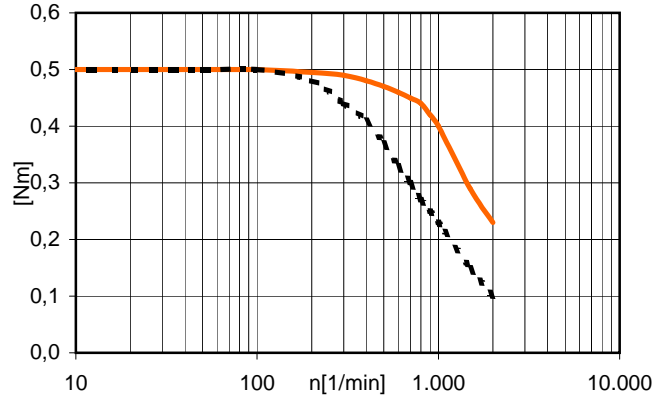
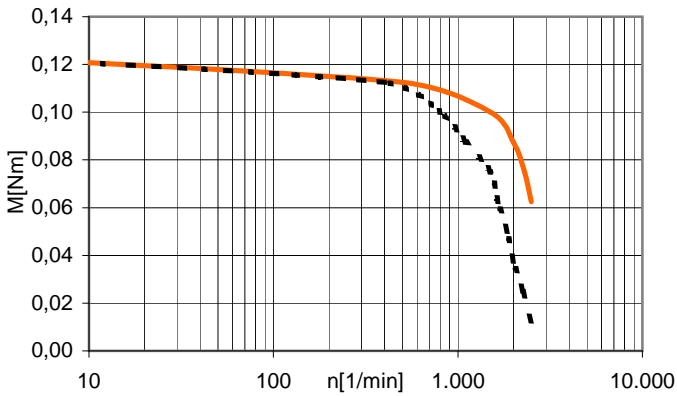

flange dimension 56 (NEMA23) MOT-AN-S-060-020-056-...	flange dimension 60 (NEMA23XL) MOT-AN-S-060-035-060-...
---	---

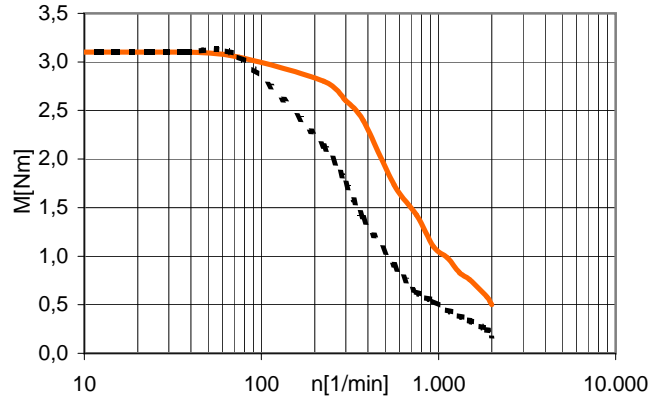
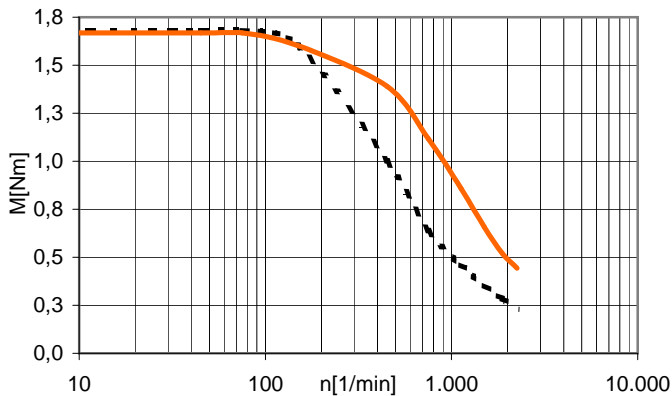

flange dimension 86 (NEMA34) MOT-AN-S-060-059-086-...

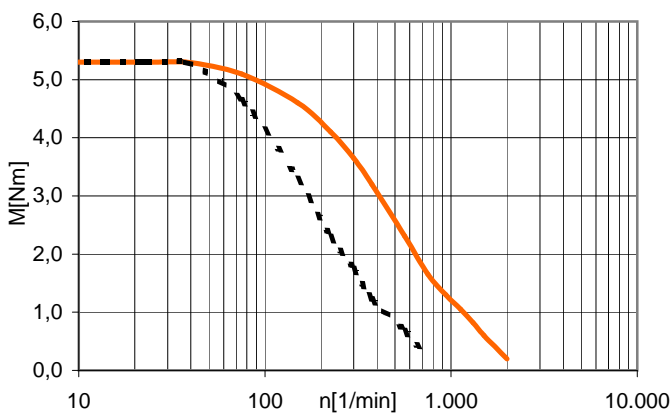

- - - - - 24VDC	— 48 VDC	characteristic based on quarter step mode
-----------------	----------	---

dimension
MOT-AN-S-060-...-L-A-AAAA / MOT-AN-S-060-...-M-A-AAAA

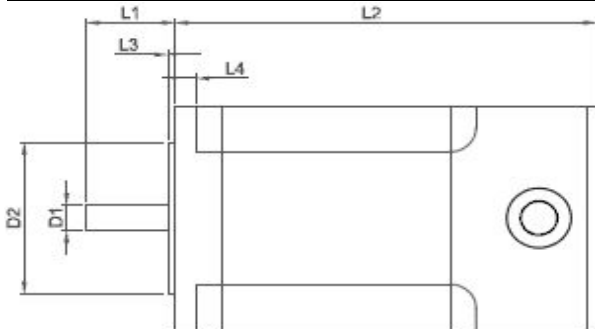

MOT-AN-S-060-...-M-C-AAAC

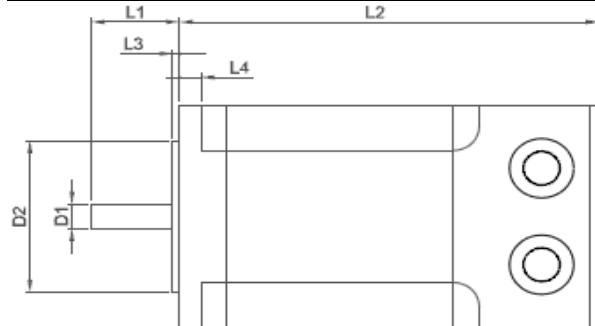

MOT-AN-S-060-...-M-D-AAAD

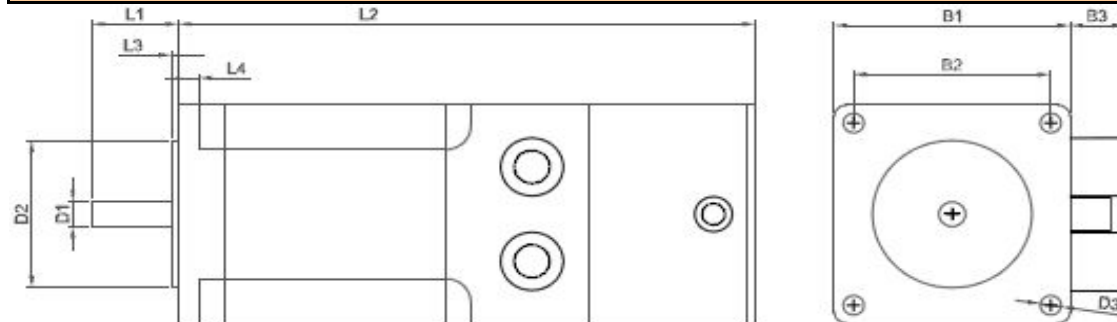

type	B1 [mm]	B2 [mm] ±0,2	B3 [mm]	D1 Ø [mm] -0,013	D2 Ø [mm] ±0,025	D3 Ø [mm]	L1 [mm] ±1	L2 [mm] ±1	L3 [mm]	L4 [mm]
MOT-AN-S-060-001-028-L-A-AAAA	28,0	23,00	-	5,00	22,00	M2,5	20,0	50	2,0	-
MOT-AN-S-060-001-028-L-C-AAAC	28,0	23,00	-	5,00	22,00	M2,5	20,0	60	2,0	-
MOT-AN-S-060-005-042-L-A-AAAA	42,3	31,00	-	5,00	22,00	M3	24,0	49	2,0	-
MOT-AN-S-060-005-042-M-A-AAAA	42,3	31,00	13	5,00	22,00	M3	24,0	70	2,0	-
MOT-AN-S-060-005-042-M-C-AAAC	42,3	31,00	13	5,00	22,00	M3	24,0	70	2,0	-
MOT-AN-S-060-005-042-M-D-AAAD	42,3	31,00	13	5,00	22,00	M3	24,0	115	2,0	-
MOT-AN-S-060-020-056-L-A-AAAA	56,4	47,14	-	6,35	38,10	5,0	20,6	76	1,6	5
MOT-AN-S-060-020-056-M-A-AAAA	56,4	47,14	13	6,35	38,10	5,0	20,6	98	1,6	5
MOT-AN-S-060-020-056-M-C-AAAC	56,4	47,14	13	6,35	38,10	5,0	20,6	98	1,6	5
MOT-AN-S-060-020-056-M-D-AAAD	56,4	47,14	13	6,35	38,10	5,0	20,6	138	1,6	5
MOT-AN-S-060-035-060-L-A-AAAA	60,0	47,14	9	8,00	38,10	4,5	20,6	88	1,6	7
MOT-AN-S-060-035-060-M-A-AAAA	60,0	47,14	13	8,00	38,10	4,5	20,6	110	1,6	7
MOT-AN-S-060-035-060-M-C-AAAC	60,0	47,14	13	8,00	38,10	4,5	20,6	110	1,6	7
MOT-AN-S-060-035-060-M-D-AAAD	60,0	47,14	13	8,00	38,10	4,5	20,6	150	1,6	7
MOT-AN-S-060-059-086-M-A-AAAA	85,8	69,50	37	14,00	73,02	6,6	37,0	118	2,0	8
MOT-AN-S-060-059-086-M-C-AAAC	85,8	69,50	37	14,00	73,02	6,6	37,0	118	2,0	8
MOT-AN-S-060-059-086-M-D-AAAD	85,8	69,50	37	14,00	73,02	6,6	37,0	188	2,0	8

cable				
part number	outer jacket	type	cable length	plug
flange dimension 42(NEMA17), 56(NEMA23), 60(NEMA23XL)				
motor - cable Ø: 5,5 mm / bending radius moved < 10m travel distance: min. 5 x d				
MAT9043737	TPE	CF9-CF.INI	3	straight
MAT9043738	TPE	CF9-CF.INI	5	straight
MAT9043740	TPE	CF9-CF.INI	10	straight
MAT9043742	TPE	CF9-CF.INI	3	angulate
MAT9043743	TPE	CF9-CF.INI	5	angulate
MAT9043745	TPE	CF9-CF.INI	10	angulate

encoder - cable Ø: 7 mm / bending radius moved < 10m travel distance: min. 10 x d				
MAT90432594-3	PVC	CF240	3	straight
MAT90432594-5	PVC	CF240	5	straight
MAT90432594-10	PVC	CF240	10	straight
MAT90436430-3	PVC	CF240	3	angulate
MAT90436430-5	PVC	CF240	5	angulate
MAT90436430-10	PVC	CF240	10	angulate

flange dimension 86(NEMA34)				
motor - cable Ø: 10,5 mm / bending radius moved < 10m travel distance: min. 6,8 x d				
MAT90439520-3	PUR	CF78.UL	3	straight
MAT90439520-5	PUR	CF78.UL	5	straight
MAT90439520-10	PUR	CF78.UL	10	straight

encoder - cable Ø: 8 mm / bending radius moved < 10m travel distance: min.. 10 x d				
MAT90439519-3	PVC	CF211	3	straight
MAT90439519-5	PVC	CF211	5	straight
MAT90439519-10	PVC	CF211	10	straight

flange dimension 42(NEMA17), 56(NEMA23), 60(NEMA23XL)				
brake/initiator - cable Ø: 4,5 mm / bending radius moved < 10m travel distance: min. 5 x d				
MAT9043716	TPE	CF9-CF.INI	3	straight
MAT9043717	TPE	CF9-CF.INI	5	straight
MAT9043719	TPE	CF9-CF.INI	10	straight
MAT9043724	TPE	CF9-CF.INI	3	angulate
MAT9043725	TPE	CF9-CF.INI	5	angulate
MAT9043727	TPE	CF9-CF.INI	10	angulate

plug straight



plug angulate



component part

More Information about our comprehensive component parts can be found at our website

www.igus.eu/drylinE-datasheets

motor flange



spacer



coupling



initiator / initiator bracket

